



CyberTouch™ 7300

2.4GHz Wireless Keyboard & Mouse Combo



Model: WKB-7300CB

QuickGuide

English

www.adesso.com

CONTENTS

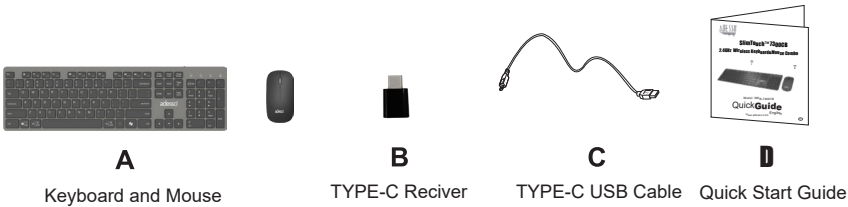

MOUSE DESCRIPTION

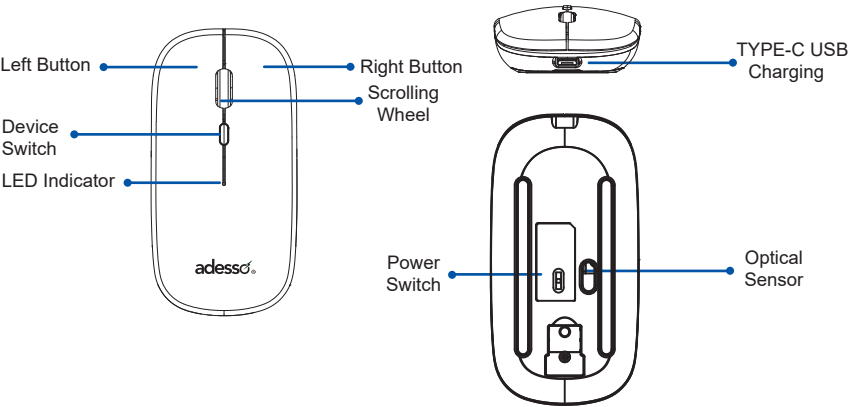

INSTALLATION

1. Turn ON your computer and plug in the TYPE-C receiver into your computer or device's available TYPE-C port.The system will automatically load the TYPE-C receiver is plug and play feature.

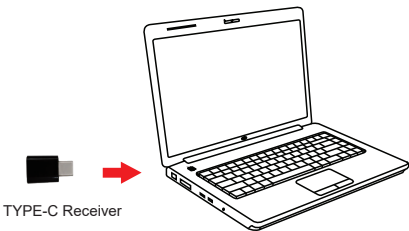

2. Turn ON your keyboard and mouse, it will be ready to use.

LIMITED WARRANTY

Adesso provides a one year limited warranty for all of its products against defects in material and workmanship.

During this period, Adesso will repair or replace any product which proves to be defective. However, Adesso will not warranty any product which has been subject to improper freight handling, shipping abuse, neglect, improper installation or unauthorized repair. The warranty will not cover products installed with components not approved by Adesso and products where the sealed assembly trace has been broken.

If you discover a defect, Adesso will, at its option, repair or replace the product at no charge to you provided you return it during the warranty period with freight charges pre-paid to Adesso. Before returning any product, you must obtain a Return Merchandise Authorization number (RMA). This RMA # must be clearly marked on the outside of the package you are returning for warranty service. Be certain to also include your name, shipping address (no PO Boxes), telephone number, and a copy of the invoice showing proof of purchase in the package.

SUPPORT

We have listed most of our FAQ's (Frequently Asked Questions) at: <http://www.adesso.com/faqs.asp>. Please visit our FAQ Service & Support pages before you contact our E-mail or Telephone Support.

Email Support: If our FAQ's do not help you resolve your issues, please email support@adesso.com

Telephone Support:
Toll Free: (800) 795-6788
9:00AM to 5:00PM PST Monday - Friday

KEYBOARD DESCRIPTION

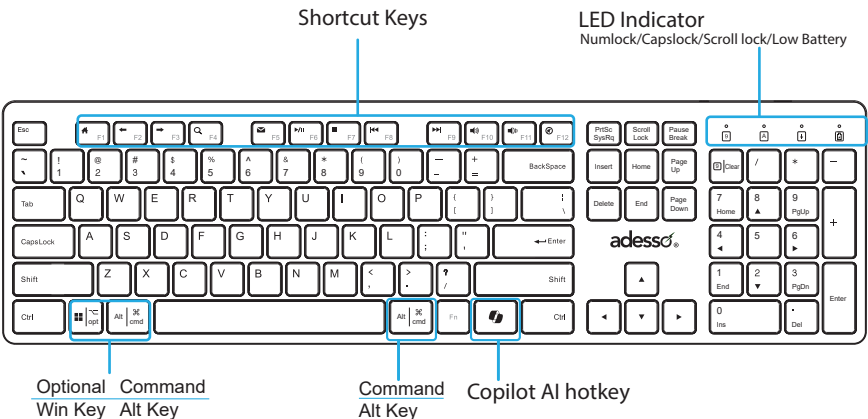

Multimedia Hotkeys	
	Launches CoPilot
	Home
	Backward
	Forward
	Search
	Email
	Play / Pause
	Stop
	Previous Track
	Next Track
	Volume Up
	Volume Down
	Mute

INTRODUCTION

Adesso® CyberTouch™ WKB-7300CB 2.4GHz Wireless Keyboard Combo is ideal for the home, office , or while on the go with an adavaned Optical Mouse. This keyboard combo features multi-functional hotkeys which can quickly access media player, multimedia controls, and Internet browser commands. it is designed with a slim and low-profile Scissor-Switch Technology for comfort, speed, and a better tactile feel. This keyboard also has a built-in lithium Polymer Rechargeable Battery which can be recharged via USB cable for long extended use.

FEATURES

- Keyboard Specifications:**
- Keyboard Layout: 104-Key US layout
 - Connection: 2.4GHz Wireless
 - Working Range: 30 feet (10m)
 - Battery: Built-in Polymer (Rechargeable)
 - Hotkeys: Up to 100 hours (continuous use)/Up to 30 days (standby mode)
 - 13 Hotkeys (CoPilot, Home , Back, Forward, Email, Search, Play/Pause, Stop, Previous Track, Next Track, Volume Up,Volume Down &Mute)
- Mouse Specifications:**
- Keyboard Dimensions: 16.25 x 4.75 x 0.50" (436 x 122.8 x 11 mm)
 - Keyboard Weight: 1.4 Lbs (625g)
 - Connection: 2.4GHz Wireless
 - Sensor: Optical
 - DPI: 800/1200/1600
 - Working Range: 30 feet(10m)
 - Battery: Built-in Polymer(Rechargeable)
 - Mouse Dimensions: 4.2 x 2.5 x 1.5" (105 x 64 x 38 mm)
 - Mouse Weight: 0.18 Lbs (80g)

REQUIREMENTS

- Platform: Windows® 8 and above Mac os 10.4 and above
- Connnectivity Technology: 2.4GHz wireless

CHARGING THE BATTERY

1. Insert the Type-C USB Charging Cable Connector into the Type-C USB charging port at top of the Keyboard and/or Mouse.
2. Insert the USB end of the Type-C USB Cable into the USB port of your computer or any 5V USB power adaptor.

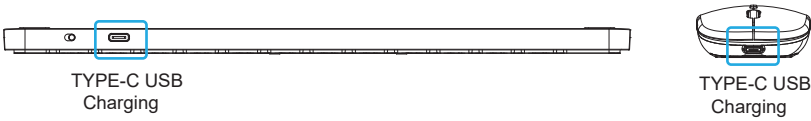

Pairing method

1. The receiver was paired with keyboard and mouse in advance, below is the pairing method in case it needs re-pairing.
- a. Turn ON your available device and plug the type-c receiver, Turn ON the keyboard and move it near receiver within 1 foot, press ESC + = in 15 seconds, the LED will blinking when pairing and Stop blinking paired.
- b. The same setup for the mouse, except press middle and right key instead.

TIPS

- When the Battery Low LED is ON, it means that the device requires charging the batteries.
- We suggest to turn “**OFF**” the devices when leaving your desk for more than an hour to save battery life for longer lasting use.

TROUBLESHOOTING

If wireless keyboard/ mouse cannot be operated, please try the following:

1. Make sure the Devices have enough power. Switch the device to ON.
2. Make sure you have connected the TYPE-C receiver correctly to the device's TYPE-C ports. Move the devices 1 foot away from the receiver in order to avoid interference while pairing connection.
3. Do the pairing process once more according the Pairing method on page 6.

Note: Wireless phone, routers and other devices that uses 2.4GHz frequency, might cause interference with wireless keyboard and mouse. Please relocate such wireless appliances away from your keyboard and mouse.